

Creston Valley Vineyard

Variety Map

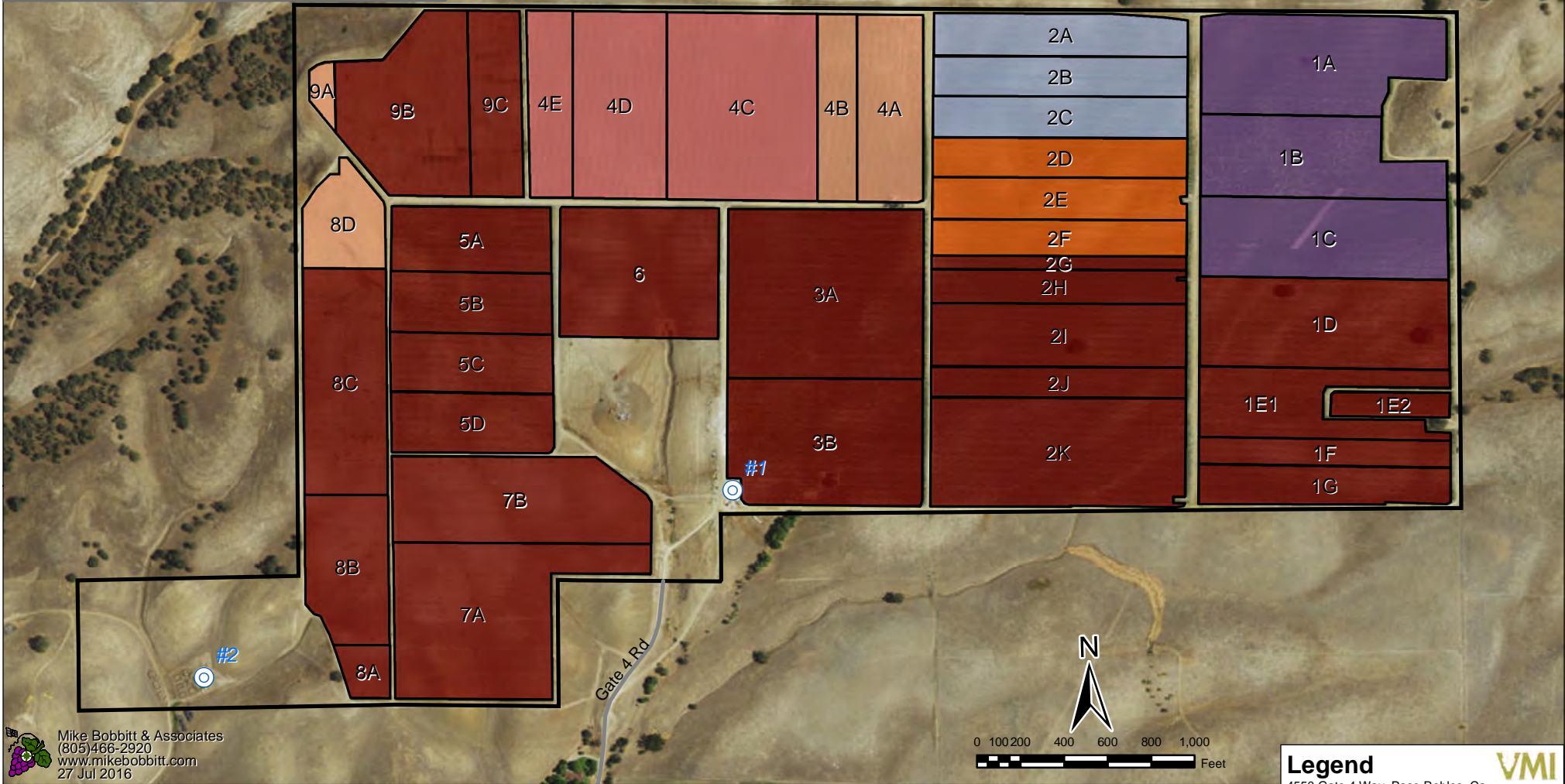

Mike Bobbitt & Associates
 (805)466-2920
 www.mikebobbitt.com
 27 Jul 2016



Legend

4550 Gate 4 Way, Paso Robles, Ca
 County: San Luis Obispo
 Williamson Act: No

- Well
- Approx. Property Line
- Cab Sauv 171.37ac
- Merlot 25.59ac
- Petit Verdot 15.37ac
- Petite Sirah 13.91ac
- Syrah 28.86ac
- Zinfandel 14.74ac
- Vineyard Blocks 269.84ac
- Non Planted 11.00ac
- Pasture, Roads 47.36ac
- Total Acres** **328.20ac**

Blocks	Variety	Clone	Rootstock	Spacing	Vines	Acres	Planted	Blocks	Variety	Clone	Rootstock	Spacing	Vines	Acres	Planted	Blocks	Variety	Clone	Rootstock	Spacing	Vines	Acres	Planted	
1A	Syrah	Noir	5BB	8x6	9915	10.92	2000	2G	Cab Sauv	337	101-14	8x6	1380	1.52	2000	5C	Cab Sauv	15	1103P	8x6	4522	4.98	2005	
1B	Syrah	887	SO4	8x6	7627	8.40	2000	2H	Cab Sauv	337	5C	8x6	3923	4.32	2000	5D	Cab Sauv	337	1103P	8x6	4476	4.93	2005	
1C	Syrah	887	101-14	8x6	8662	9.54	2000	2I	Cab Sauv	337	1103P	8x6	6874	7.57	2000	6A	Cab Sauv	167	1103P	8x5	10890	10.00	2012	
1D	Cab Sauv	337	3309C	8x6	9770	10.76	2000	2J	Cab Sauv	04	1103P	8x6	3550	3.91	2000	7A	Cab Sauv	15	101-14	8x5	14747	13.54	2014	
1E1	Cab Sauv	04	110R	8x6	6002	6.61	2000	2K	Cab Sauv	337	110R	8x6	12494	13.76	2000	7B	Cab Sauv	08	101-14	8x5	11161	10.25	2014	
1E2	Cab Sauv	04	110R	8x6	1398	1.54	2000	3A	Cab Sauv	07	110R	8x6	14891	16.40	2000	8A	Cab Sauv	15	101-14	8x5	1360	1.25	2014	
1F	Cab Sauv	337	101-14	8x6	3133	3.45	2000	3B	Cab Sauv	15	5BB	8x6	10941	12.05	2000	8B	Cab Sauv	08	1103P	8x5	6195	5.69	2014	
1G	Cab Sauv	15	5BB	8x6	4449	4.90	2000	4A	Petite Sirah	Durif	1103P	8x6	5848	6.44	2000	8C	Cab Sauv	07	140R	8x5	9936	9.12	2014	
2A	Petit Verdot	02	5BB	8x6	4694	5.17	2016	4B	Petite Sirah	03	1103P	8x6	2951	3.25	2000	8D	Petite Sirah	04	101-14	8x5	3899	3.58	2014	
2B	Petit Verdot	02	5C	8x6	4731	5.21	2016	4C	Merlot	343	1103P	8x6	12249	13.49	2000	9A	Petite Sirah	04	101-14	8x5	698	0.64	2014	
2C	Petit Verdot	02	5BB	8x6	4531	4.99	2016	4D	Merlot	14	1103P	8x6	7609	8.38	2000	9B	Cab Sauv	06	101-14	8x5	10548	9.69	2014	
2D	Zinfandel	1A	5C	8x6	4531	4.99	2000	4E	Merlot	314	1103P	8x6	3378	3.72	2000	9C	Cab Sauv	33	101-14	8x5	5184	4.76	2014	
2E	Zinfandel	1A	5BB	8x6	4513	4.97	2000	5A	Cab Sauv	06	1103P	8x6	4894	5.39	2005	Total Planted						257,417	269.84	
2F	Zinfandel	1A	5C	8x6	4340	4.78	2000	5B	Cab Sauv	02	1103P	8x6	4522	4.98	2005									

Disclaimer: The information herein was compiled from multiple publically available sources, is considered reliable and the most current available; it is, however, provided without warranty, either express or implied. No liability is assumed either directly or indirectly. Contact a licensed Land Surveyor for any questions regarding legal property boundaries